

WATER SERVICES COORDINATION ACT 1995
 NYABING OPERATING AREA
 (SEWERAGE AND NON-POTABLE WATER SERVICES)

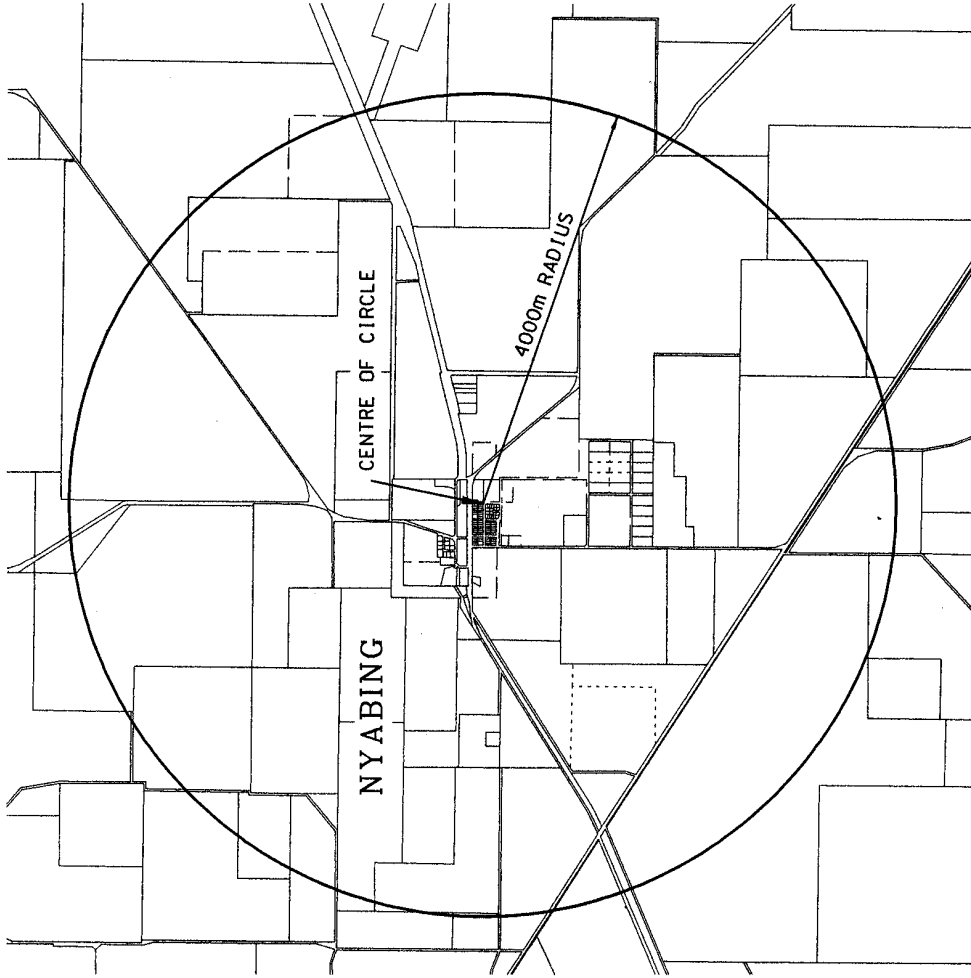

CENTRE OF CIRCLE
 THE SOUTHEASTERN CORNER OF
 TOWN LOT 30, CORNER OF
 ASPENDALE AND BOURKE STREETS,
 NYABING TOWNSITE.

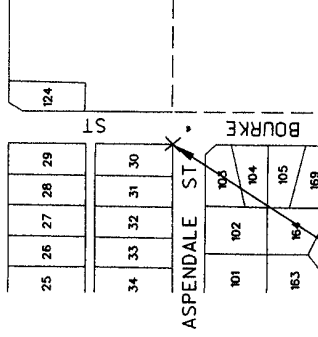

DESIGN FILE: WAWA A32281 PC: 2801

DATE		31-05-02	11-12-95	31-05-02
NO.		B	A	B
DESCRIPTION		AMENDED SERVICE	ORIGINAL ISSUE	
M/W/G/				
DPR				
CHK				
APR				
APPROVED: <i>Peter Olney</i> COORDINATOR OF WATER SERVICES DATE: 14 June 2002				
DRAWN		M. OLNEY		
FILE NO.				
CHECKED				
SCALE		1:50,000		
APPROVED				
DATE		31 MAY 2002		
PLAN NO.		OWR-OA-038		
ISSUE		B		
ORIG. SIZE		A3		

WATER SERVICES COORDINATION ACT 1995
PINGRUP OPERATING AREA
(SEWERAGE AND NON-POTABLE WATER SERVICES)

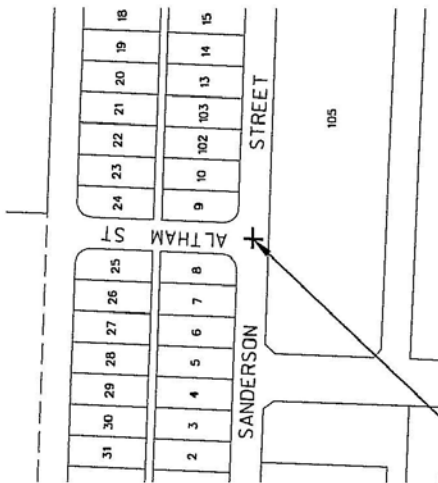
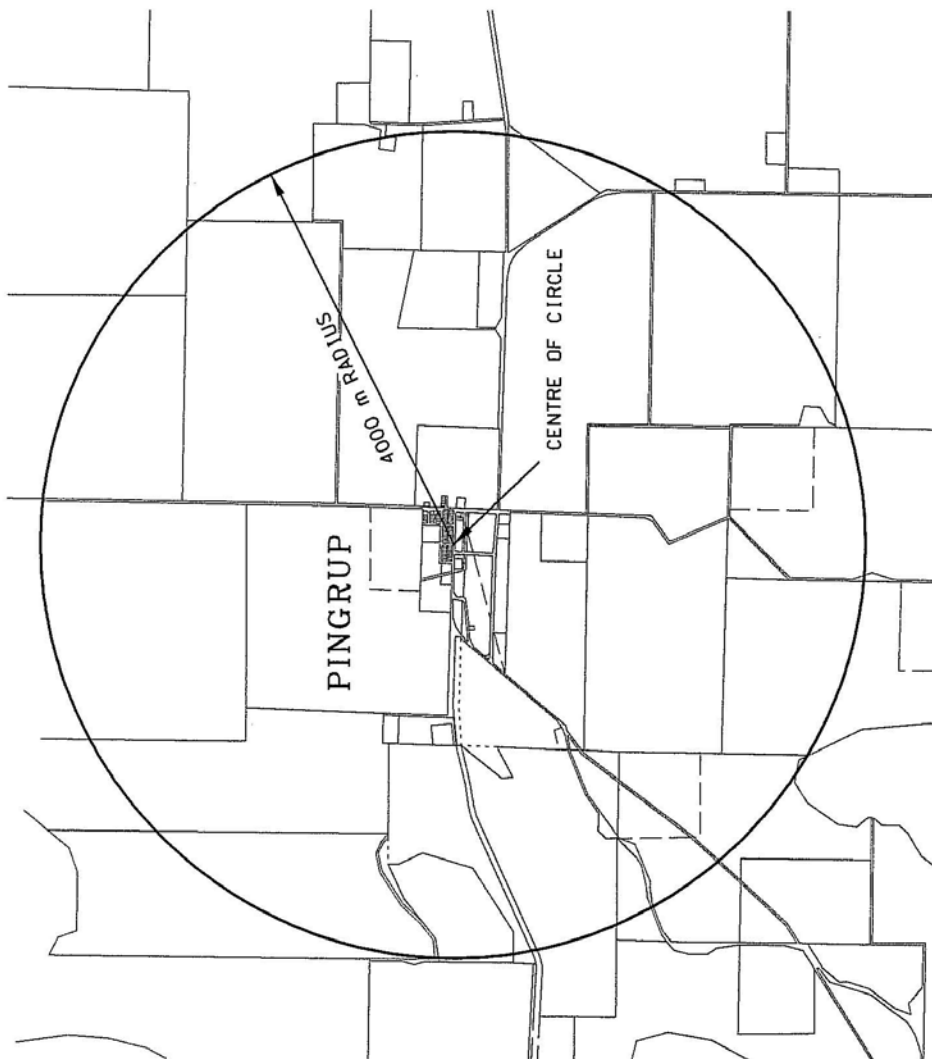

CENTRE OF CIRCLE
 THE INTERSECTION OF THE CENTRE LINE
 OF SANDERSON STREET WITH THE
 SOUTHERLY PROLONGATION OF THE CENTRE
 LINE OF ALTHAM STREET, PINGRUP TOWNSITE.

DESIGN FILE: WAWA A32284 PC: 2801

DATE	No.	DESCRIPTION	DRN	CHK	APR
31-5-02	A	AMENDED SERVICE	N.H.		
12-12-95	A	ORIGINAL ISSUE	N.H. W.G/W.G.		

APPROVED: <i>[Signature]</i> COORDINATOR OF WATER SERVICES		CHECKED: M. OLNEY FILE No.
DATE: 14 June 2002	APPROVED DATE: 31 MAY 2002	SCALE: 1:50,000
WATER SERVICES COORDINATION ACT 1995 PINGRUP OPERATING AREA (SEWERAGE AND NON-POTABLE WATER SERVICES) LICENSEE: SHIRE OF KENT		PLAN No. OWR-OA-039 ISSUE B ISSUE SIZE A3