

INSET 1

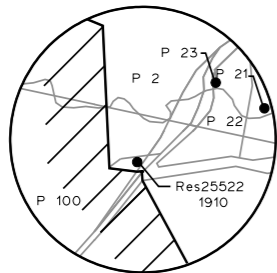

INSET 2

INDIAN OCEAN

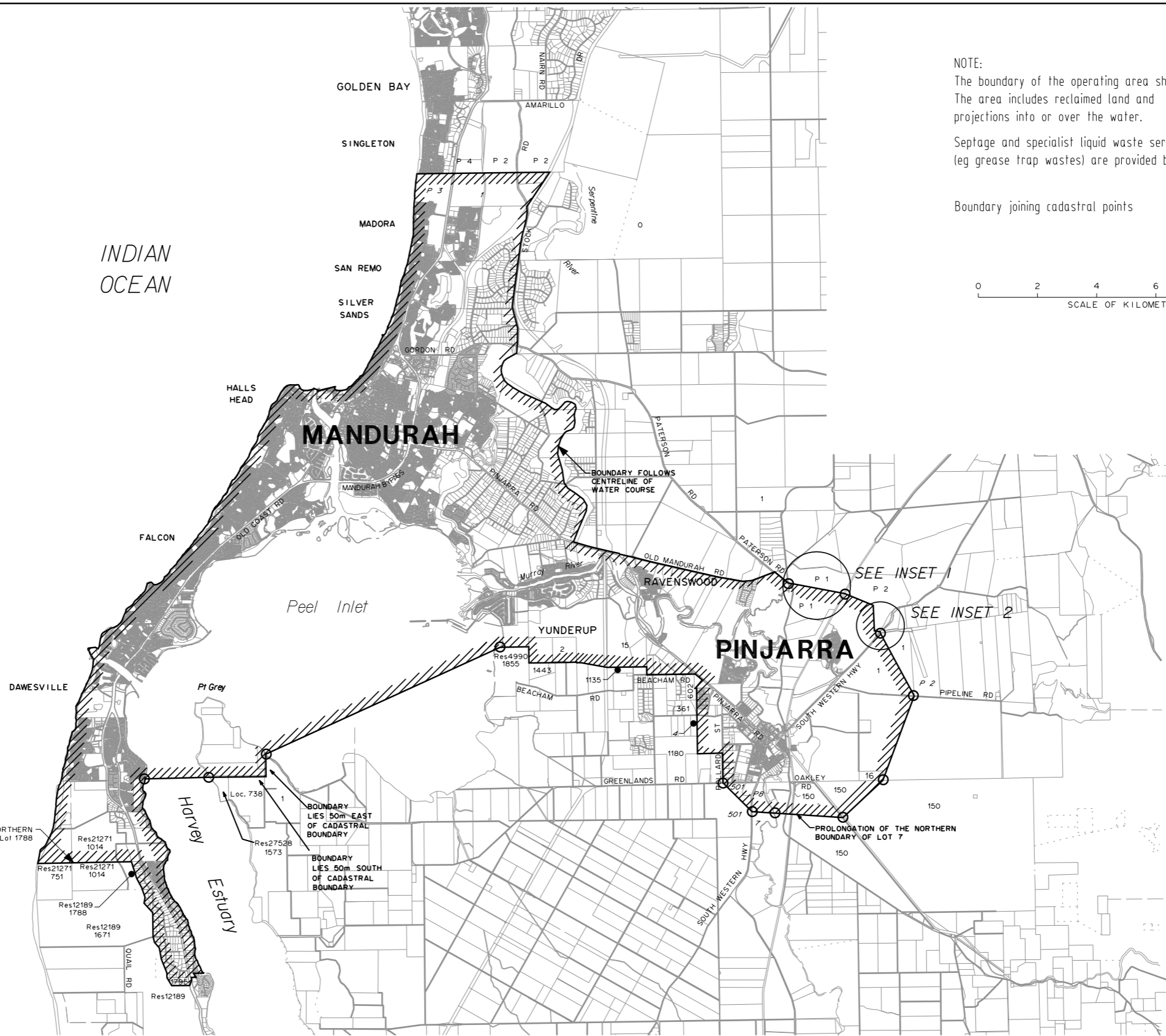

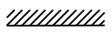
NOTE:
 The boundary of the operating area shown 
 The area includes reclaimed land and projections into or over the water.
 Septage and specialist liquid waste services (eg grease trap wastes) are provided by others.

Boundary joining cadastral points 



13-01-2009	E	OPERATING AREA EXTENDED TO INCLUDE PT GREY	AM	KT
15-05-2002	D	SINGLETON AND GOLDEN BAY INCLUDED IN METROPOLITAN	SM	JH
02-05-2001	C	INCLUSION OF SINGLETON AND GOLDEN BAY	SM	JH
17-11-2000	B	OPERATING AREA AMENDMENTS	SM	JH
24-06-1999	A	AMENDED OPERATING AREA AND CHANGED NAME	SM	JH
25-01-1996	I	ORIGINAL ISSUE - DRG OWR-OA-104	BS	WG
DATE	No.	DESCRIPTION	DRN	CHK



APPROVED : L. ROWE
 CHAIRMAN
 Economic Regulation Authority

DATE : 03/03/2009

WATER SERVICES LICENSING ACT 1995
 MANDURAH/PINJARRA OPERATING AREA
 SEWERAGE SERVICES
 LICENSEE : WATER CORPORATION

DRAWN S.MASTERS	CHECKED J.HARRIS	PLAN NO. OWR-OA-104	ISSUE E	ORIG SIZE A3
FILE No.	DATE 24 JUNE 1999			